

**1932 Radiator Shell,
Hood, Fenders and
Running boards**



1932 Passenger Grille

Filled Style

Stock Style



Grille Ornament, Passenger

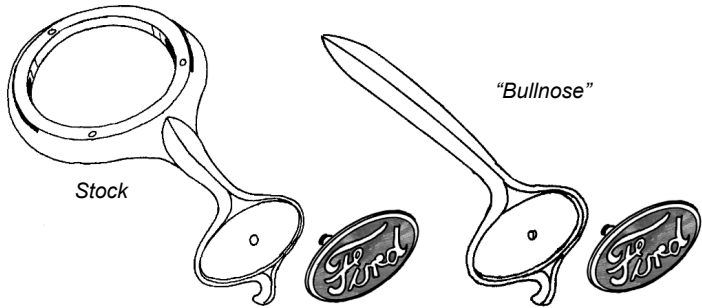

B-8215	Radiator Cap Bezel, chrome	60.00 ea
B-8215-BN	"Bullnose" for Filled Shell	65.00 ea
B-8212	Ford Emblem, chrome with blue background	25.00 ea

Ford Emblem, Pickup & Panel

Chrome with blue porcelain background
Note: 1932 Pickup does not use an ornament



B-8212	25.00 ea
--------	----------

Radiator Caps

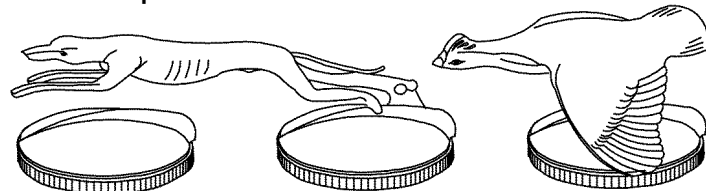

B-8100	Stock cap (includes internal guts), chromed	37.50 ea
B-8100-G	Greyhound cap (guts not included), chromed	not.avbl
B-8100-Q	Quail cap (includes internal guts), chromed	95.00 ea
B-8100-K	1932-34 Radiator cap internal guts	10.00 set

Grille Shells

Wescott fiberglass 1932 grille shells fit original and Walker radiators. They have the proper flanges for mounting the grille insert, rear trim stainless, and original type hood lacing. The "stock" style grille has the boss for mounting the grille ornament, the "filled" style does not.

GS32PS	Grille shell, "Stock Style", fiberglass, excellent fit	400.00 ea
B-8150-S	Grille shell, "Stock Style", stamped steel, good fit	325.00 ea
GS32PF	Grille shell, "Filled Style", fiberglass, excellent fit	400.00 ea
B-8150-F	Grille shell "Filled Style", stamped steel, good fit	325.00 ea

Grille Inserts

Stainless steel outer ring, grille bars installed.

B-8200-IA	Grille insert, w/plain steel bars, with crank hole:	425.00 ea
B-8200-IC	Grille insert, w/stainless bars, with crank hole	400.00 ea
B-8200-ID	Grille insert w/stainless bars, no crank hole	350.00 ea
B-8151-A	Replacement grille bars, steel	not.avbl
B-8151-SS	Replacement grille bars, stainless	not.avbl
B-8126	Replacement Crank hole bezel, stainless	27.50 ea

Trim Ring

B-8234	Trim Ring, stainless	85.00 ea
--------	----------------------	----------

Mounting bolts

A-8201-BM	Grille shell to radiator mount bolt set	2.50 set
-----------	---	----------

1932 Accessory Grille Bug Screen

B-18700	Includes mount springs	not.avbl
---------	------------------------	----------

* Parts with price listed as "not.avbl" are not known to be available at this time, but are listed for reference.

1932 Radiator Shell, Hood, Fenders and Running Boards, cont

Grille, Pickup & Panel

The pickup grille is stamped as part of the grille shell. A passenger grille and insert will replace the pickup grille if desired.



Grille w/shell

B-8150-PU (steel) 900.00 ea

Grille inner apron

B-8151-PU (steel) 75.00 ea

Front Splash Aprons

Fiberglass

Stock Style:

FSA32A 200.00 ea

Chopped 2", for clearance on lowered cars

FSA32AC 200.00 ea

Bubbled, for front mount steering rack

FSA32AB 200.00 ea

Apron to frame mounting stud set, plain

B-16525-S 30.00 set

Apron to stud screws, stainless, set of 4

B-16028-SS 5.00 set

Apron/grille anti rattle felt block

B-16527-FB 10.00 ea



1932 Stock and Street Rod Hoods

Steel hoods
by Rootlieb.

1 piece
top

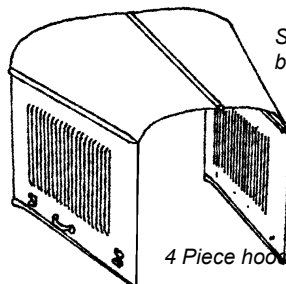

4 Piece hood

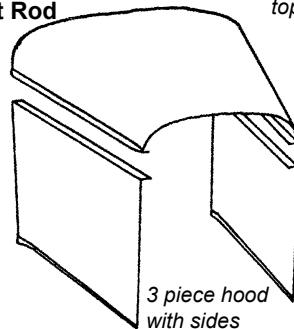

3 piece hood
with sides

Hood top includes center hinge.
Side panels are complete with hood
handles and hinge rods.

Hood top can be used a top panel
only. Side panels do not have
handles.
Hood hinges and top panel braces
not included, sold separately.

Hood Tops

Stock Hinge

One
Piece

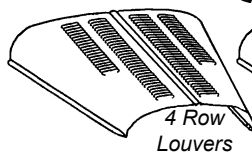

4 Row
Louvers

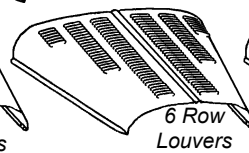

6 Row
Louvers

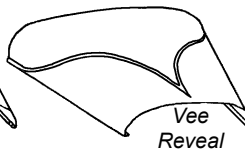

Vee
Reveal

	4 Piece		3 Piece (1 piece top)	
Top, plain	B-16710	375.00 ea	B-16710-3	350.00 ea
Top, 4 row louvers	B-16710-L4	475.00 ea	B-16710-3L4	475.00 ea
Top, 6 row louvers	B-16710-L6	525.00 ea	B-16710-3L6	525.00 ea
Top, V reveal	B-16710-3V	525.00 ea		

Hood Sides

20 Louver

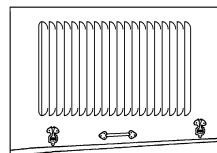

25 Louver

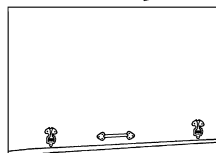
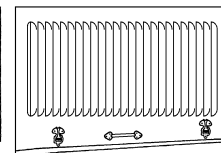

Plain

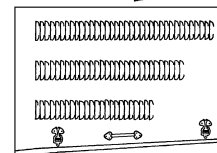

3 Row Hot Rod

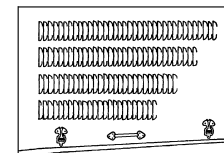

4 Row Hot Rod

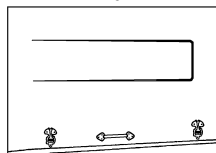

Single Scoop

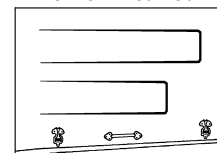

Double Scoop

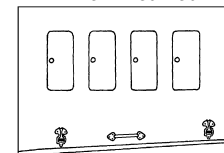

4 Side Door

	4 Piece		3 Piece (1 piece top)	
Sides, 20 louver	B-16712-A	350.00 pr	B-16713-A	295.00 pr
Sides, 25 louver	B-16712-B	350.00 pr	B-16713-B	295.00 pr
Sides 25 lvr exact repro	B-16712-BE	900.00 pr		
Sides, 3 row hot rod	B-16712-H3	350.00 pr	B-16713-H3	295.00 pr
Sides, 4 row hot rod	B-16712-H4	350.00 pr	B-16713-H4	295.00 pr
Sides, plain	B-16712-P	350.00 pr	B-16713-P	295.00 pr
Sides, single scoop	B-16712-S1	675.00 pr	B-16713-S1	625.00 pr
Sides, double scoop	B-16712-S2	1000.00 pr	B-16713-S2	950.00 pr
Sides, 4 door	B-16712-D	875.00 pr		

* Parts with price listed as "not.avbl" are not known to be available at this time, but are listed for reference.

1932 Radiator Shell, Hood, Fenders and Running Boards, cont

1928-36 Accessory Hood Supports, Stainless Steel

HR-16780-SS Mount to radiator support rods 45.00 ea

Hood Hinge (Stock 4 piece)

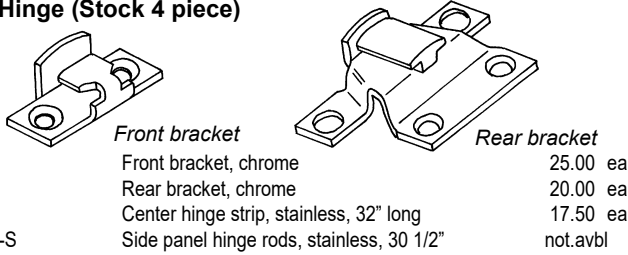

Hood Latches (original type)

Hood Latches

B-16750	Plain	12.50 ea
B-16750-SS	Stainless	20.00 ea

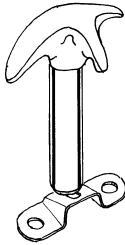

Hood Latch Mount Screw Set

B-16750-MS Stainless Steel 7.50 set

Hood Latch to Fender Pads, Rubber

B-16750-PAD	oblong type	17.50 ea
B-35630	oval type	5.00 pr

Hood Side Hardware and Bumpers

Center bumper bracket

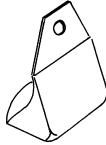

A-16636	Hood side handles, Plain, w/rivets	25.00 pr
A-16636-SS	Hood side handles, Stainless, w/screws	35.00 pr
B-16751-S	Hood latch catch brackets, set of 4 w/rubbers	30.00 set
A-16751-RS	Dummy (threaded) rivets, chrome, set of 20	10.00 set
B-16751-SS	1932 Hood latch catch set, stainless	40.00 set
B-16761	Hood bumper set	27.50 set
B-16718-SS	Center bumper bracket (mounts to fender)	32.50 ea

Hinge and Braces for 3-Piece Hoods

Top Panel Braces

3/8" round steel braces provide extra support. This minimizes flexing and helps to avoid cracking paint and smooths operation of hidden hinges.

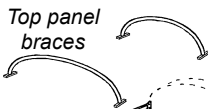

A-16714-BDF Braces not.avbl

Hidden hinge and latch kit:

By DF Metalworks. Includes hinges, latches, and side panel lower alignment pins. Hardware and instructions are included.

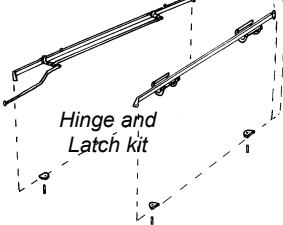

B-16711-DF	LH Open	not.avbl
B-16711-DF2	2 Way Open	not.avbl

Hood Lacing

We recommend fabric or hard rubber lacing for 4 piece hoods, foam rubber should only be used with 3 piece hoods.

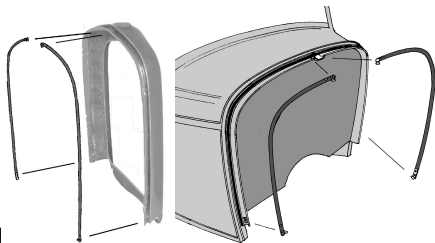

B-16739-S	Grille sl	
B-16740-S	Cowl, Fabric, w/clips	22.50 ea
B-16739-RS	Grille shell, hard rubber w/clips	40.00 ea
B-16740-RS	Cowl, Fabric, hard rubber w/clips	50.00 ea
HR-16739	Foam rubber, 3/8" x 3/16" (most rad shells)	15.00 ea
HR-16740	Foam rubber, 5/8" x 3/8" (most cowls)	25.00 ea

Front Fenders, Fiberglass



RFF32A	RH plain	500.00 ea
LFF32A	LH plain	500.00 ea

Front Fenders with Spare Tire Well, fiberglass

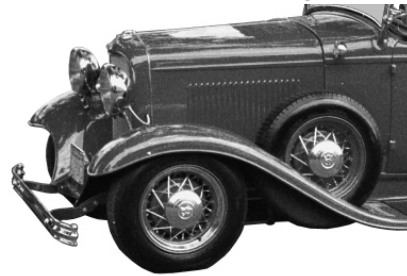

RFF32AW6	RH w/6" sidemount tire well	625.00 ea
LFF32AW6	LH w/6" sidemount tire well	625.00 ea
RFF32AW8	RH w/8" sidemount tire well	625.00 ea
LFF32AW8	LH w/8" sidemount tire well	625.00 ea

1932 Rear Fenders, Fiberglass



RFF32CR	RH: Coupe & Roadster	375.00 ea
LRF32CR	LH: Coupe & Roadster	375.00 ea
RRF32SPH	RH: Sedan & Phaeton	375.00 ea
LRF32SPH	LH: Sedan & Phaeton	375.00 ea
RRF32PU	RH: Pickup, Panel, Station wagon	375.00 ea
LRF32PU	LH: Pickup, Panel, Station wagon	375.00 ea

Front Fender Brackets and Bolts

Fender Brackets

Fits All Models, Stamped Steel
B-16025 RH or LH. 60.00 ea

Fender Bracket to Fender Bolts

Stainless
B-16026-S2 1/2" long 5.00 pr

Fender to Frame Slotted Screws

Stainless Steel
A-16027-SS Set of 4 5.00 set

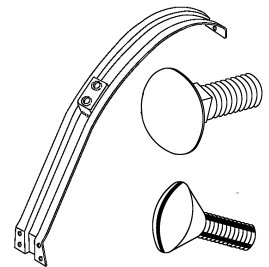

* Parts with price listed as "not.avbl" are not known to be available at this time, but are listed for reference.

1932 Radiator Shell, Hood, Fenders and Running Boards, cont

Fender Welt

Black vinyl, 25 ft. length

48-16070-B	3/16" bead	17.50 ea
48-16070-D	1/4" bead	17.50 ea

Vinyl, clad w/stainless bead, 8 ft. length

48-16070-SS	7/32" bead	30.00 ea
-------------	------------	----------

Vinyl, COLORED, Use part suffix to indicate color

Maroon: -MR, Caramel: -CR, Medium Blue: -BLM, Red: -RD, Dark Brown: -BRD, Dark Green: -GRD, White: -WH, Grey: -GY, Bright Orange: -OR, Yellow: -YL, Bright Red: -RR

48-16070-xx	25 ft length, Specify Color	40.00 ea
-------------	-----------------------------	----------

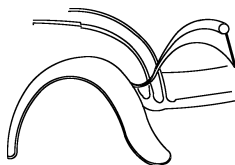

Rear Wheelwell Studs

Large head fender mount bolt, spot welds to wheelwell of steel body.

AH-1173	Set of 4	1.00 ea
---------	----------	---------

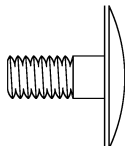

Passenger Rear Frame Horn Covers, Fiberglass

These fit better than the steel reproductions. Left cover has opening for gas tank neck.

RHC32P	Right	200.00 ea
LHC32P	Left	200.00 ea



Gas Tank Top Panel, 1932 Passenger, Fiberglass

Use to cover a replacement tank or as a dummy tank to finish the back of car. This panel will not fit over an original tank.

GTC32P	285.00 ea
--------	-----------



1932 Rear Frame Horn Cover Seal

Anti rub rubber from frame horn to gas tank. Includes molded seal and four horn cover to body bumpers.

B-16398	27.50 ea
---------	----------

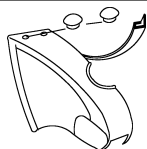

Custom Rear Rolled Pans, Fiberglass

Fit Wescott Roadsters perfectly, may require slight filling on sides in wheel well area on original or other fiberglass bodies.



RRP32CR3	3" Deep, Roadster & 5 Window Coupe (only)	300.00 ea
RRP32CR6	6" Deep, Roadster & 5 Window Coupe (only)	300.00 ea



Running Boards

Stock Style
Stamped steel with molded rubber cover.

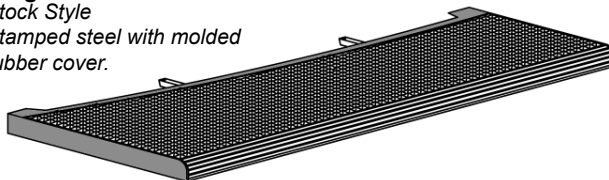

B-16450-S	Running Boards, rubber covered	600.00 pr
-----------	--------------------------------	-----------

1932 Running Boards

Smoothie Style
Stamped steel
no cover.

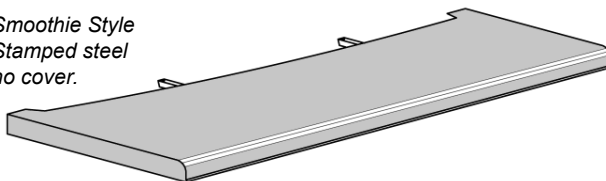

B-16450-SM	Running Boards, smooth style	350.00 pr
------------	------------------------------	-----------

1932 Running Board Brackets

Stamped Steel. Mounts into frame channel. Four brackets are used on each car. These may not fit boxed frames.

B-5125	set of 4	32.50 set
--------	----------	-----------



Running Board to Fender and Frame Mounting Bolts

B-16455-MS	1932 All Models, set	not.avbl
------------	----------------------	----------

* Parts with price listed as "not.avbl" are not known to be available at this time, but are listed for reference.