

## 1936 Passenger Grille, Hood, Fenders and Running Boards

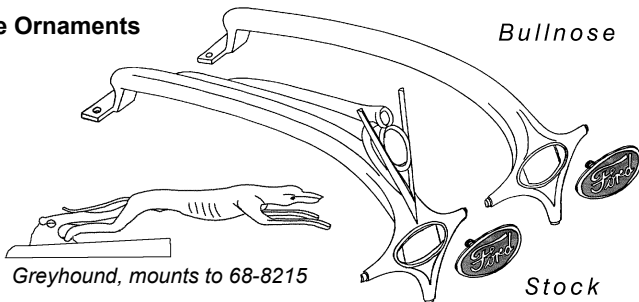

### Grille Ornaments



68-8215	Ornament, Stock V8 style, chrome plated	145.00 ea
68-8215-BN	Ornament, Bullnose style, chrome plated	145.00 ea
40-8212-B	Ford Emblem, Chrome with blue background	20.00 ea
68-8100-G	Accessory Greyhound, chrome	not.avbl

### Grille

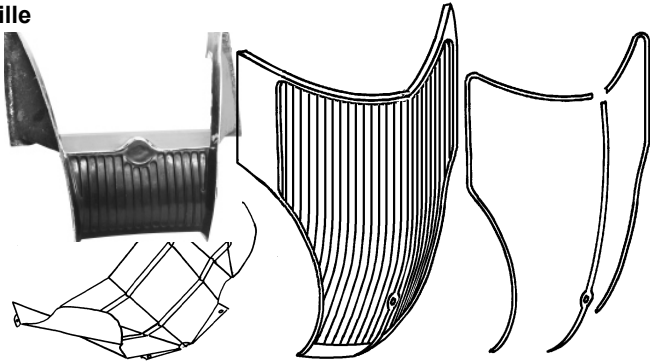

#### Grille:

*Stamped Steel. A fair quality import which will require some effort for perfect fit. We strongly recommend fitting this part before paint or plating.*

68-8200-P	Grille, plain, w/crank hole	850.00 ea
68-8200-PN	Grille, plain, no crank hole	850.00 ea

#### 1936 Passenger Grille Trim

68-8157	Center trim, stainless	30.00 ea
68-8184/5	Side trim, stainless	100.00 pr
68-20001	Center trim mounting clips	7.50 set
68-20002	Outer trim mounting clips	10.00 set

#### 1936 Passenger Grille Bug Screen

68-18700	Accessory bug screen, includes clips	not.avbl
----------	--------------------------------------	----------

#### Grille Inner Panels

GSP36P	Grille inner panel, fiberglass	250.00 ea
68-16554	Grille to Crossmember Shield, steel	70.00 ea

### Hood

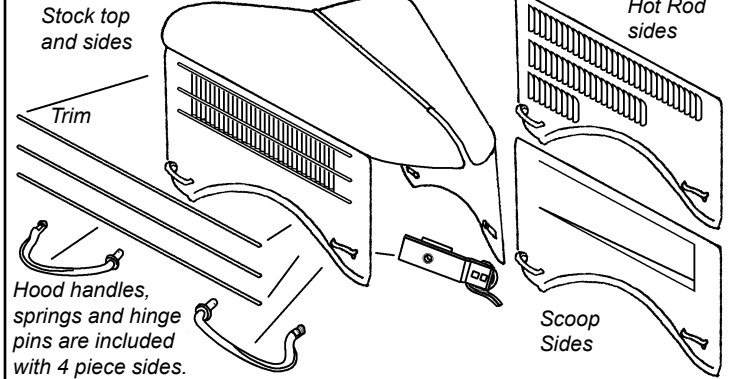

Hood Parts	4 Piece		3 Piece	
Top			not.avbl	not.avbl
Sides, Stock louvers			not.avbl	not.avbl
Sides, Hot Rod Louvers	68-16712-H	450.00 pr	68-16713-H	450.00 pr
Sides, Plain	68-16712-P	400.00 pr	68-16713-P	400.00 pr
Sides, Scoop	68-16712-S	725.00 pr	68-16713-S	725.00 pr

#### Hood Side Trim

68-16722-S	Side trim, stainless, set of 6 with clips	275.00 set
68-20004	Side trim clip set (32 pcs)	20.00 set

#### Hood Handles and Springs

40-16636-BR	Handle, RH front, LH rear, bronze	15.00 ea
40-16636-BL	Handle, LH front, RH rear, bronze	15.00 ea
48-16644/5-B	Handles, set of 4, polished stainless	not.avbl
40-16637-BR	Bracket & Spring, RH front, LH rear	25.00 ea
40-16637-BL	Bracket & Spring, LH front, RH rear	25.00 ea

#### Hood Hinges (for 4 piece hoods)

##### Hinge Brackets:

B-8220	Rear, stainless	25.00 ea
68-8226	Front, plain	15.00 ea

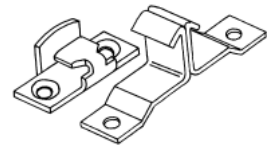

##### Center Hinge Strip

40-16632	stainless, 33"	30.00 ea
----------	----------------	----------

##### Side panel hinge rods

68-16631-S	stnls, 34 1/2"	40.00 pr
------------	----------------	----------

#### Hood Lacing on Grille or Cowl

*We recommend fabric or hard rubber lacing for 4 piece hoods, foam rubber should only be used with 3 piece hoods.*

68-16739-S	Grille: 1936 Passenger, rubber w/rivets	7.50 ea
68-16740-S	Cowl: 1936 Passenger, fabric, w/screws	22.50 ea
HR-16739	Foam rubber, 3/8" x 3/16" (most rad shells)	15.00 ea
HR-16740	Foam rubber, 5/8" x 3/8" (most cowls)	25.00 ea

#### 1928-36 Accessory Hood Supports, Stainless Steel

HR-16780-SS	Mount to radiator support rods	45.00 ea
-------------	--------------------------------	----------

#### 1936 Pass Hood Latch and Bumper Brackets



68-16628-RE	Front latch bracket on fender, stainless Replacement style without embossing	35.00 ea
68-16759-KS	Rear hood bumper bracket on fender, stainless	37.50 pr

#### Hood Rubber Bumper Sets

68-16761	1936 Passenger (w/corner rubber)	27.50 set
----------	----------------------------------	-----------

\* Parts with price listed as "not.avbl" are not known to be available at this time, but are listed for reference.

## 1936 Passenger Grille, Hood, Fenders and Running Boards, cont

### Passenger Front Fenders, Fiberglass



RFF36P	RH Front fender	700.00 ea
LFF36P	LH Front fender	700.00 ea
RFE36P	RH Fender/grille extension	230.00 ea
LFE36P	LH Fender/grille extension	230.00 ea
RFI36P	RH Inner fender	200.00 ea
RFI36P	LH Inner fender	200.00 ea
REI36P	RH Extension inner panel	60.00 ea
LEI36P	LH Extension inner panel	60.00 ea

### Front Fender Extension Stainless Beads

*This is the formed stainless welt that goes between front fender and front fender extension; 4 pc set.*

68-16035 55.00 set

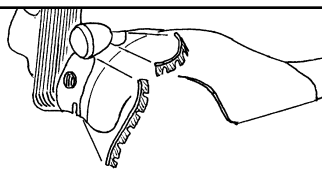

### Front Fender Horn Grilles

#### Horn Grille

68-16156-S stainless 20.00 ea

#### Horn grille rubber pads:

68-16156-P rubber 15.00 pr

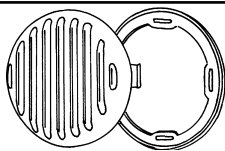

### Fender Brackets and Mounting

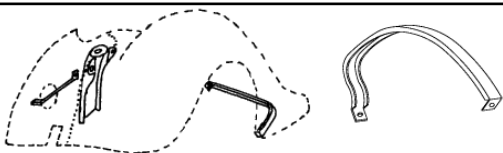

68-16025-R	Front fender/headlight support, RH	not.avbl
68-16025-L	Front fender/headlight support, LH	not.avbl
48-16067-R	Front support bracket to crossmember strut, RH	30.00 ea
48-16067-L	Front support bracket to crossmember strut, LH	30.00 ea
48-16094	Front fender skirt bracket, RH or LH	35.00 ea
48-16391	Rear fender bracket, RH or LH	35.00 ea
48-16008-SK	Fender washer set, 28 pieces	10.00 ea
AH-3145	Cage nut, 5/16-24	5.00 ea

### Fender Welt

#### Black vinyl, 25 ft. length

48-16070-B 3/16" bead 17.50 ea

48-16070-D 1/4" bead 17.50 ea

#### Vinyl, clad w/stainless bead, 8 ft. length

48-16070-SS 7/32" bead 30.00 ea

#### Vinyl, COLORED, Use part suffix to indicate color

Maroon: -MR, Caramel: -CR, Medium Blue: -BLM, Red: -RD, Dark Brown: -BRD, Dark Green: -GRD, White: -WH, Grey: -GY, Bright Orange: -OR, Yellow: -YL, Bright Red: -RR

48-16070-xx 25 ft length, Specify Color 40.00 ea

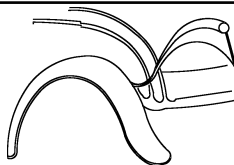

### Coupe, Roadster, Cabriolet Rear Fenders,

#### Fiberglass

**Right:**  
RRF36CR 550.00 ea

**Left:**  
LRF36CR 550.00 ea



### Sedan & Phaeton Rear Fenders,

#### Fiberglass

**Right:**  
RRF36SPH 550.00 ea

**Left:**  
LRF36SPH 550.00 ea



### Station Wagon & Sedan Delivery Rear Fenders,

#### Fiberglass

*Trim inner flange of fender to fit Sedan Delivery*

**Right:**  
RRF3539SD 550.00 ea

**Left:**  
LRF3539SD 550.00 ea



### Teardrop Fender Skirts, Fiberglass

*Excellent fiberglass reproductions of the aftermarket bubbled fender skirts that were so popular in the '50's. Includes locking arms to latch to the top of the fender, clamps to the bottom of the skirts to the front and rear of the wheel opening, stainless screws, and rubber seals.*



FST3536F Fender Skirts, fiberglass 800.00 pr

### 1935-36 Passenger Running Boards Fiberglass, smoothie style

*Fiberglass boards are very strong, over 1/4" thick.*



*These have the proper arch for excellent fit and appearance*

RRB3536PS RH, smooth running board 500.00 ea  
LRB3536PS LH, smooth running board 500.00 ea

### Steel boards and rubber covers:

*Steel boards with vulcanized covers are excellent quality and fit.*

48-16450/1-BD Steel boards w/molded rubber cover not.avbl  
48-16450/1 Molded rubber replacement covers 300.00 pr  
48-16455-MB 1935-48 Running board mount bolt 1.00 ea

### Running Board Moldings

Stainless  
48-16462-S 100.00 pr

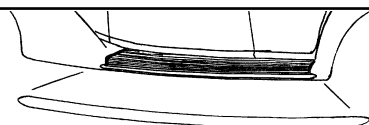

\* Parts with price listed as "not.avbl" are not known to be available at this time, but are listed for reference.

19701 SE Highway 212  
Damascus, OR 97089

**2024 Catalog**  
Prices and descriptions subject to change

1-800-523-6279  
www.wescottsauto.com