

## 1937 Passenger Grille, Hood, Fenders & Running Boards

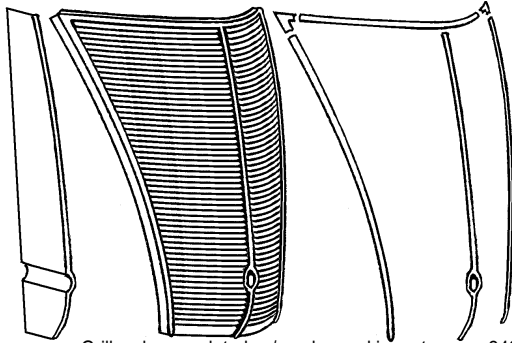

### Grille



78-8200-C	Grille, chrome plated, w/crank, good import	2400.00	ea
78-8200-P	Grille, plain, w/crank hole, good import	2000.00	ea
78-8242/3	Grille upper corner brackets (hood side mount)	65.00	pr
78-8209	Grille center vertical brace	105.00	ea
78-8157	Grille trim, center, stainless	30.00	ea
78-8184/5	Grille trim, sides, stainless	80.00	pr
78-8264	Grille trim, top, stainless	32.50	ea
78-8168/9	Grille trim, corners, stainless	25.00	pr
78-16720/1-CP	Grille trim clip set	25.00	ea

### Grille "Ford V8 85" Emblem

Chrome with blue insert

78-8217 not.avbl



### Grille Inner Baffle

Fiberglass

GSP37P 200.00 ea

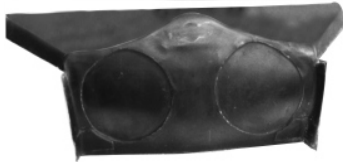

### Grille to Crossmember Shield

Fiberglass

FSB37P 150.00 ea



## 1937 Passenger Hood Handles & Ornaments

### Hood handle, chrome:

78-8215 not.avbl

### Hood handle base, chrome

78-8218 not.avbl

### Hood handle base gasket:

78-8227 2.00 ea

### Hood latch cam (mounts to handle)

78-16628 35.00 ea

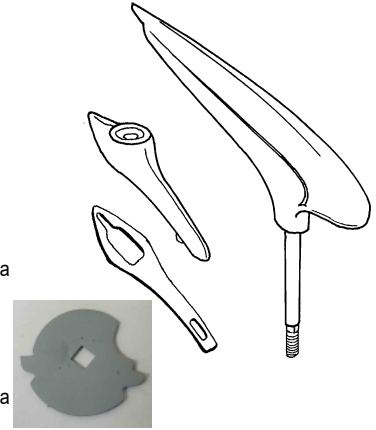

## Hood

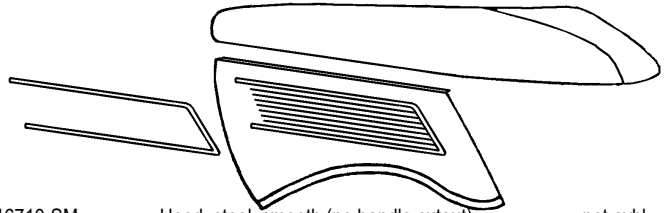

78-16710-SM	Hood, steel, smooth (no handle cutout)	not.avbl
HDS37PSR	Hood side panel RH, smooth, fiberglass	not.avbl
HDS37PSL	Hood side panel LH, smooth, fiberglass	not.avbl
78-16722-S	Hood side trim	205.00 ea
78-16720/1-CP	Hood side mount clip set	25.00 ea

## Hood Hinges and Props

78-16796/7	Hinges, plain	70.00	pr
78-16796/7-SS	Hinges, Stainless	85.00	pr
91A-16796-HK	Hinge bolts	7.50	ea
78-16746/7	Hinge Pads, rubber	10.00	pr
78-16782	Props (ratchet type)	not.avbl	
01A-16782-MS	Prop shoulder screws, plain	10.00	pr
01A-16782-MSS	Prop shoulder screw, stainless	12.50	pr

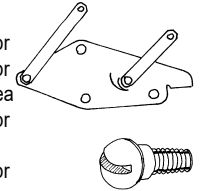

## Hood Lacing and Hood Rubber Bumpers

78-16740-S	Hood lacing, rubber, w/screws,	10.00	ea
78-16761	Hood rubber bumper set	27.50	set

## Front Fenders

Fiberglass



RFF37P		.00	ea
LFF37P	LH Front fender	725.00	ea
RFI37P	RH inner fender	250.00	ea
RFI37P	LH inner fender	250.00	ea

\* Parts with price listed as "not.avbl" are not known to be available at this time, but are listed for reference.

## 1937 Passenger Grille, Hood, Fenders and Running Boards, cont

### Coupe & Convertible Rear Fenders

Fiberglass

**Right:**  
RRF37C 550.00 ea

**Left:**  
LRF37C 550.00 ea



### Slantback Sedan Rear Fenders

Fiberglass

**Right:**  
RRF37SS 550.00 ea

**Left:**  
LRF37SS 550.00 ea



### Humpback Sedan Rear Fenders

Fiberglass

**Right:**  
RRF37TS 550.00 ea

**Left:**  
LRF37TS 550.00 ea



### Sedan Delivery & Station Wagon Rear Fenders

Fiberglass

**Right:**  
RRF3539SD 550.00 ea

**Left:**  
LRF3539SD 550.00 ea



### Teardrop Fender Skirts, Fiberglass

Excellent fiberglass reproductions of the aftermarket bubbled fender skirts that were so popular in the '50's. Includes locking arms to latch to the top of the fender, clamps to the bottom of the skirts to the front and rear of the wheel opening. stainless screws. and rubber seals.

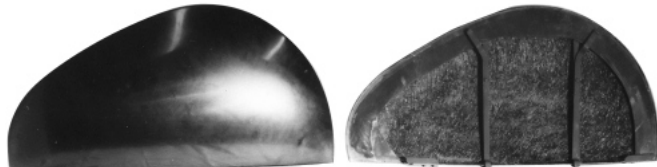

FST3740F Fender Skirts, fiberglass 800.00 pr

### Fender Brackets

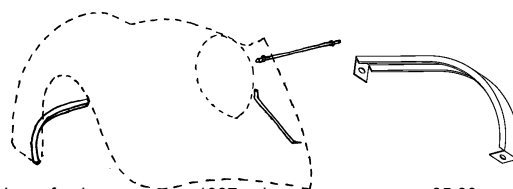

78-8232-B	Inner fender cross stay, 1937 only	35.00 ea
48-16067-R	RH Inner fender to frame brace	30.00 ea
48-16067-L	LH Inner fender to frame brace	30.00 ea
78-16094	Front fender skirt brace	50.00 ea
78-16391	Rear fender skirt brace	30.00 ea

### 5/16-24 Cage Nuts

Welded to body and frame for fender and running board mounting.

AH-3145 Cage nut 5.00 ea

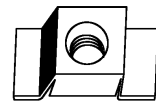

### Fender Welt

#### Black vinyl, 25 ft. length

48-16070-B	3/16" bead	17.50 ea
48-16070-D	1/4" bead	17.50 ea

#### Vinyl, clad w/stainless bead, 8 ft.

48-16070-SS	7/32" bead	30.00 ea
-------------	------------	----------

#### Vinyl, COLORED, Use part suffix to indicate color

Maroon: -MR, Caramel: -CR, Medium Blue: -BLM, Red: -RD, Dark Brown: -BRD, Dark Green: -GRD, White: -WH, Grey: -GY, Bright Orange: -OR, Yellow: -YL, Bright Red: -RR

48-16070-xx 25 ft length, Specify Color 40.00 ea

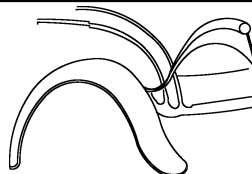

### Running Boards

Fiberglass boards are very strong, over 1/4" thick and have the proper arch for excellent fit and appearance.

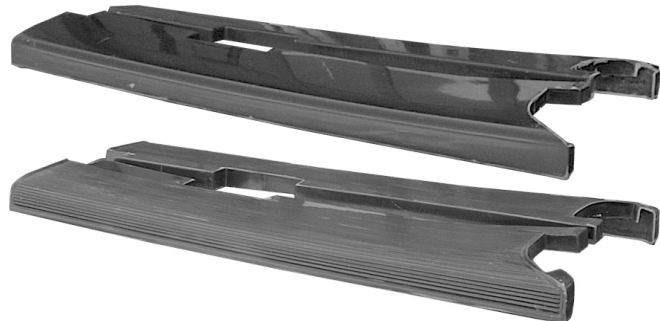

#### Fiberglass, smoothie style:

RRB3739PS	RH, smooth running board	500.00 ea
LRB3739PS	LH, smooth running board	500.00 ea

#### Fiberglass, w/molded ribs to simulate original style:

RRB3739P	RH, w/molded ribs	500.00 ea
LRB3739P	LH, w/molded ribs	500.00 ea

#### Steel boards and rubber covers:

Steel boards with vulcanized rubber covers are excellent quality

78-16450/1-BD	Running boards w/molded covers	1400.00 pr
78-16450/1	Molded rubber replacement covers	300.00 pr
48-16455-MB	1935-48 Running board mount bolt	1.00 ea
78-16453-S	Running board mount bolt set, 37-48	12.50 set

### 1937-39 Running Board Stainless Moldings



78-16462-S 1937-38 Passenger, 1939 Standard 110.00 pr

\* Parts with price listed as "not.avbl" are not known to be available at this time, but are listed for reference.