

**1932 Radiator Shell,
Hood, Fenders and
Running boards**



1932 Passenger Grille

Filled Style

Stock Style



Grille Ornament, Passenger

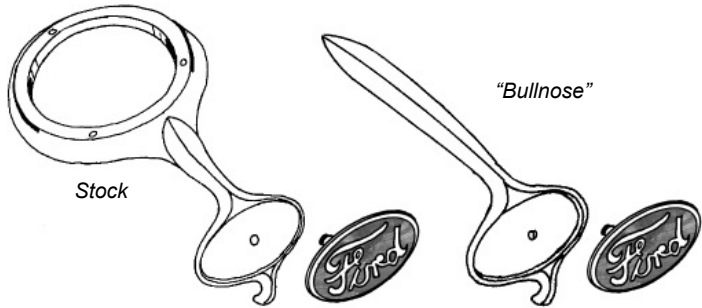

B-8215	Radiator Cap Bezel, chrome	50.00 ea
B-8215-BN	"Bullnose" for Filled Shell	60.00 ea
B-8212	Ford Emblem, chrome with blue background	20.00 ea

Ford Emblem, Pickup & Panel

Chrome with blue porcelain background
Note: 1932 Pickup does not use an ornament



B-8212	20.00 ea
--------	----------

Radiator Caps

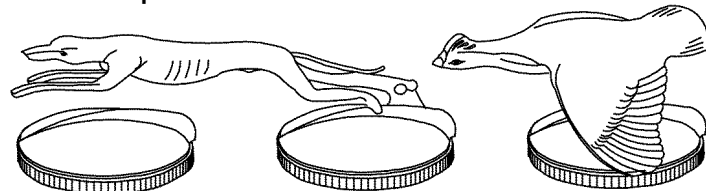

B-8100	Stock cap (includes internal guts), chromed	22.50 ea
B-8100-G	Greyhound cap (guts not included), chromed	not.avbl
B-8100-Q	Quail cap (includes internal guts), chromed	60.00 ea
B-8100-K	1932-34 Radiator cap internal guts	10.00 set

Grille Shells

Wescott fiberglass 1932 grille shells fit original and Walker radiators. They have the proper flanges for mounting the grille insert, rear trim stainless, and original type hood lacing. The "stock" style grille has the boss for mounting the grille ornament, the "filled" style does not.

GS32PS	Grille shell, "Stock Style", fiberglass, excellent fit	300.00 ea
B-8150-S	Grille shell, "Stock Style", stamped steel, good fit	325.00 ea
GS32PF	Grille shell, "Filled Style", fiberglass, excellent fit	300.00 ea
B-8150-F	Grille shell "Filled Style", stamped steel, good fit	325.00 ea

Grille Inserts

Stainless steel outer ring, grille bars installed.

B-8200-IA	Grille insert, w/plain steel bars, with crank hole:	425.00 ea
B-8200-IC	Grille insert, w/stainless bars, with crank hole	375.00 ea
B-8200-ID	Grille insert w/stainless bars, no crank hole	300.00 ea
B-8151-A	Replacement grille bars, steel	2.00 ea
B-8151-SS	Replacement grille bars, stainless	5.00 ea
B-8126	Replacement Crank hole bezel, stainless	25.00 ea

Trim Ring

B-8234	Trim Ring, stainless	55.00 ea
--------	----------------------	----------

Mounting bolts

A-8201-BM	Grille shell to radiator mount bolt set	2.00 set
-----------	---	----------

1932 Accessory Grille Bug Screen

B-18700	Includes mount springs	65.00 ea
---------	------------------------	----------

* Parts with price listed as "not.avbl" are not known to be available at this time, but are listed for reference.

1932 Radiator Shell, Hood, Fenders and Running Boards, cont

Grille, Pickup & Panel

The pickup grille is stamped as part of the grille shell. A passenger grille and insert will replace the pickup grille if desired.



Grille w/shell

B-8150-PU (steel) 700.00 ea

Grille inner apron

B-8151-PU (steel) 75.00 ea

Front Splash Aprons

Fiberglass

Stock Style:

FSA32A 140.00 ea

Chopped 2", for clearance on lowered cars
FSA32AC 140.00 ea

Bubbled, for front mount steering rack
FSA32AB 140.00 ea

Apron to frame mounting stud set, plain
B-16525-S 15.00 set

Apron to stud screws, stainless, set of 4
B-16028-SS 2.00 set

Apron/grille anti rattle felt block
B-16527-FB 7.50 ea



1932 Stock and Street Rod Hoods

Steel hoods by Rootlieb.

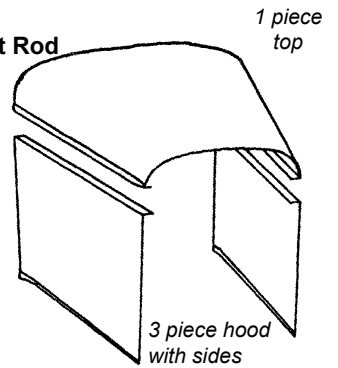
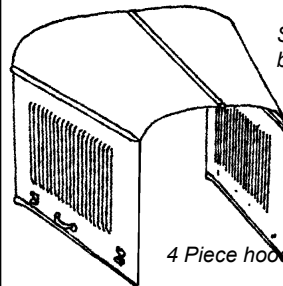

Hood top includes center hinge. Side panels are complete with hood handles and hinge rods.

Hood top can be used a top panel only. Side panels do not have handles. Hood hinges and top panel braces not included, sold separately.

Hood Tops

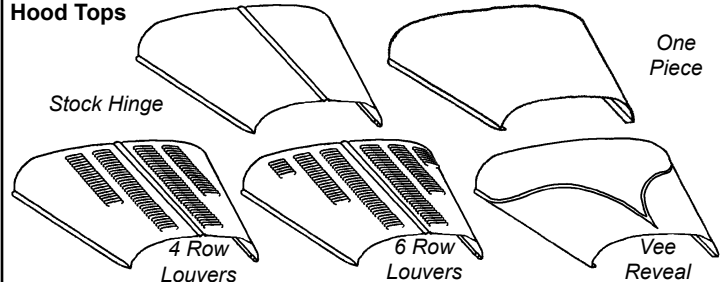

	4 Piece		3 Piece (1 piece top)	
Top, plain	B-16710	350.00 ea	B-16710-3	350.00 ea
Top, 4 row louvers	B-16710-L4	450.00 ea	B-16710-3L4	450.00 ea
Top, 6 row louvers	B-16710-L6	500.00 ea	B-16710-3L6	500.00 ea
Top, V reveal	B-16710-3V	500.00 ea		

Hood Sides

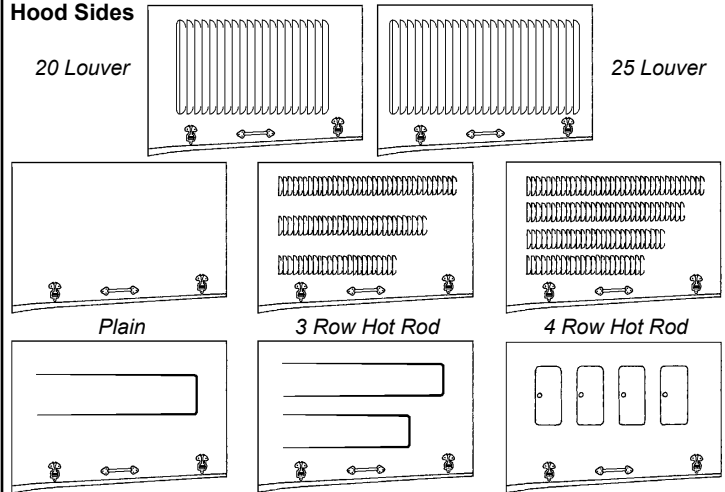

	4 Piece		3 Piece (1 piece top)	
Sides, 20 louver	B-16712-A	350.00 pr	B-16713-A	275.00 pr
Sides, 25 louver	B-16712-B	350.00 pr	B-16713-B	275.00 pr
Sides 25 lvr exact repro	B-16712-BE	875.00 pr		
Sides, 3 row hot rod	B-16712-H3	350.00 pr	B-16713-H3	257.00 pr
Sides, 4 row hot rod	B-16712-H4	350.00 pr	B-16713-H4	257.00 pr
Sides, plain	B-16712-P	350.00 pr	B-16713-P	275.00 pr
Sides, single scoop	B-16712-S1	650.00 pr	B-16713-S1	600.00 pr
Sides, double scoop	B-16712-S2	975.00 pr	B-16713-S2	925.00 pr
Sides, 4 door	B-16712-D	850.00 pr		

* Parts with price listed as "not.avbl" are not known to be available at this time, but are listed for reference.

1932 Radiator Shell, Hood, Fenders and Running Boards, cont

1928-36 Accessory Hood Supports, Stainless Steel

HR-16780-SS Mount to radiator support rods 45.00 ea

Hood Hinge (Stock 4 piece)

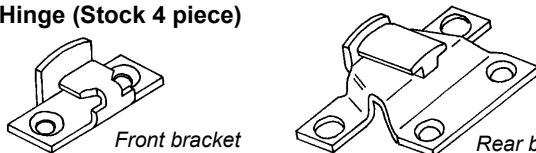

<p><i>Front bracket</i></p> <p>B-8220 Front bracket, chrome 12.50 ea</p> <p>B-8221 Rear bracket, chrome 17.50 ea</p> <p>B-16632 Center hinge strip, stainless, 32" long 17.50 ea</p> <p>B-16631-S Side panel hinge rods, stainless, 30 1/2" 17.50 pr</p>	<p><i>Rear bracket</i></p>
--	----------------------------

Hood Latches (original type)

Hood Latches

B-16750 Plain 12.50 ea

B-16750-SS Stainless 20.00 ea

Hood Latch Mount Screw Set

B-16750-MS Stainless Steel 5.00 set

Hood Latch to Fender Pads, Rubber

B-16750-PAD oblong type 17.50 ea

B-35630 oval type 5.00 pr

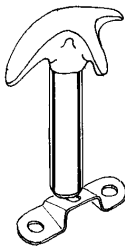

Hood Side Hardware and Bumpers

Center bumper bracket

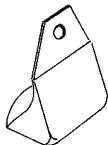

A-16636	Hood side handles, Plain, w/rivets	25.00 pr
A-16636-SS	Hood side handles, Stainless, w/screws	30.00 pr
B-16751-S	Hood latch catch brackets, set of 4 w/rubbers	30.00 set
A-16751-RS	Dummy (threaded) rivets, chrome, set of 20	5.00 set
B-16751-SS	1932 Hood latch catch set, stainless	40.00 set
B-16761	Hood bumper set	22.50 set
B-16718-SS	Center bumper bracket (mounts to fender)	17.50 ea

Hinge and Braces for 3-Piece Hoods

Top Panel Braces

3/8" round steel braces provide extra support. This minimizes flexing and helps to avoid cracking paint and smooths operation of hidden hinges.

A-16714-BDF Braces 90.00 set

Hidden hinge and latch kit:

By DF Metalworks. Includes hinges, latches, and side panel lower alignment pins. Hardware and instructions are included.

B-16711-DF LH Open 375.00 set

B-16711-DF2 2 Way Open 475.00 set

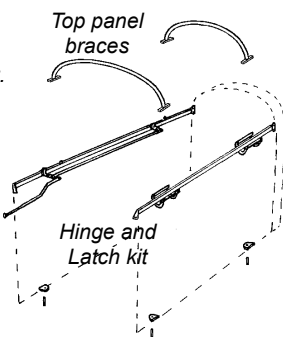

Hood Lacing

We recommend fabric or hard rubber lacing for 4 piece hoods, foam rubber should only be used with 3 piece hoods.

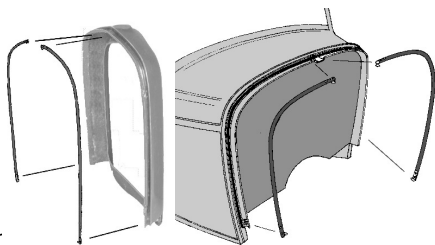

B-16739-S	Grille sl	
B-16740-S	Cowl, Fabric, w/clips	15.00 ea
B-16739-RS	Grille shell, hard rubber w/clips	40.00 ea
B-16740-RS	Cowl, Fabric, hard rubber w/clips	50.00 ea
HR-16739	Foam rubber, 3/8" x 3/16" (most rad shells)	10.00 ea
HR-16740	Foam rubber, 5/8" x 3/8" (most cowls)	12.50 ea

Front Fenders, Fiberglass



RFF32A	RH plain	400.00 ea
LFF32A	LH plain	400.00 ea

Front Fenders with Spare Tire Well, fiberglass

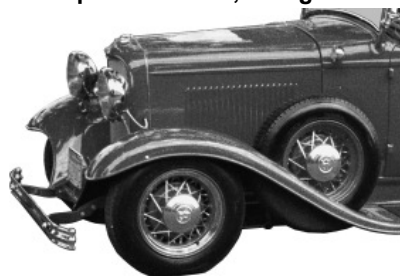

RFF32AW6	RH w/6" sidemount tire well	500.00 ea
LFF32AW6	LH w/6" sidemount tire well	500.00 ea
RFF32AW8	RH w/8" sidemount tire well	500.00 ea
LFF32AW8	LH w/8" sidemount tire well	500.00 ea

1932 Rear Fenders, Fiberglass



RRF32CR	RH: Coupe & Roadster	300.00 ea
LRF32CR	LH: Coupe & Roadster	300.00 ea
RRF32SPH	RH: Sedan & Phaeton	300.00 ea
LRF32SPH	LH: Sedan & Phaeton	300.00 ea
RRF32PU	RH: Pickup, Panel, Station wagon	300.00 ea
LRF32PU	LH: Pickup, Panel, Station wagon	300.00 ea

Front Fender Brackets and Bolts

Fender Brackets

Fits All Models, Stamped Steel

B-16025 RH or LH. 40.00 ea

Fender Bracket to Fender Bolts

Stainless

B-16026-S2 1/2" long 2.50 pr

Fender to Frame Slotted Screws

Stainless Steel

A-16027-SS Set of 4 2.50 set

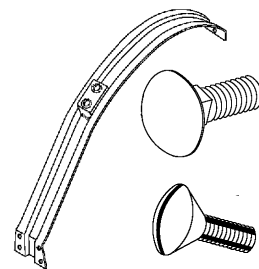

* Parts with price listed as "not.avbl" are not known to be available at this time, but are listed for reference.

1932 Radiator Shell, Hood, Fenders and Running Boards, cont

Fender Welt

Black vinyl, 25 ft. length

48-16070-B	3/16" bead	17.50 ea
48-16070-D	1/4" bead	17.50 ea

Vinyl, clad w/stainless bead, 8 ft. length

48-16070-SS	7/32" bead	22.50 ea
-------------	------------	----------

Vinyl, COLORED, Use part suffix to indicate color

Maroon: -MR, Caramel: -CR, Medium Blue: -BLM, Red: -RD, Dark Brown: -BRD, Dark Green: -GRD, White: -WH, Grey: -GY, Bright Orange: -OR, Yellow: -YL, Bright Red: -RR

48-16070-xx	25 ft length, Specify Color	35.00 ea
-------------	-----------------------------	----------

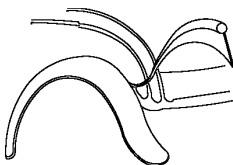

Rear Wheelwell Studs

Large head fender mount bolt, spot welds to wheelwell of steel body.

AH-1173	Set of 4	2.50 set
---------	----------	----------

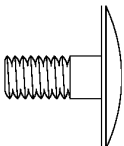

Passenger Rear Frame Horn Covers, Fiberglass

These fit better than the steel reproductions. Left cover has opening for gas tank neck.

RHC32P	Right	150.00 ea
LHC32P	Left	150.00 ea



Gas Tank Top Panel, 1932 Passenger, Fiberglass

Use to cover a replacement tank or as a dummy tank to finish the back of car. This panel will not fit over an original tank.

GTC32P	220.00 ea
--------	-----------



1932 Rear Frame Horn Cover Seal

Anti rub rubber from frame horn to gas tank. Includes molded seal and four horn cover to body bumpers.

B-16398	17.50 ea
---------	----------

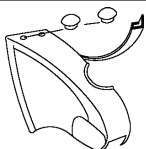

Custom Rear Rolled Pans, Fiberglass

Fit Wescott Roadsters perfectly, may require slight filling on sides in wheel well area on original or other fiberglass bodies.



RRP32CR3	3" Deep, Roadster & 5 Window Coupe (only)	250.00 ea
RRP32CR6	6" Deep, Roadster & 5 Window Coupe (only)	250.00 ea



Running Boards

Stock Style
Stamped steel with molded rubber cover.

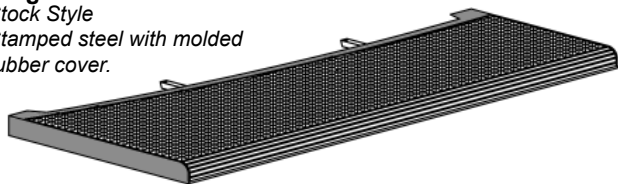

B-16450-S	Running Boards, rubber covered	600.00 pr
-----------	--------------------------------	-----------

1932 Running Boards

Smoothie Style
Stamped steel
no cover.

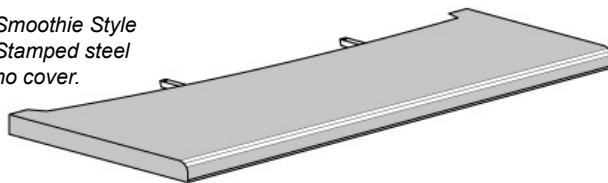

B-16450-SM	Running Boards, smooth style	350.00 pr
------------	------------------------------	-----------

1932 Running Board Brackets

Stamped Steel. Mounts into frame channel. Four brackets are used on each car. These may not fit boxed frames.

B-5125	set of 4	32.50 set
--------	----------	-----------

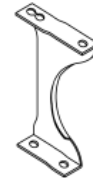

Running Board to Fender and Frame Mounting Bolts

B-16455-MS	1932 All Models, set	15.00 set
------------	----------------------	-----------

* Parts with price listed as "not.avbl" are not known to be available at this time, but are listed for reference.