

1935 Passenger Grille, Hood, Fenders & Running Boards



Grille Ornament

Ornament, Chromed

48-8215 110.00 ea

Ford Emblem

Chrome with blue background

40-8212-B 20.00 ea

Accessory Greyhound

Chrome, Mounts to ornament

48-8100-G not.avbl

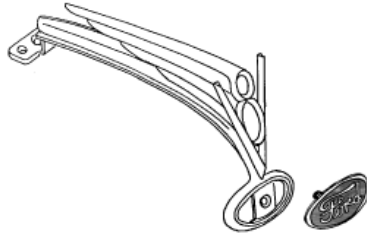

1935 Passenger Grille

Grille:

48-8200 not.avbl

Grille trim set with mount clips:

Stainless Steel

48-8234 110.00 ea

Grille trim mount clip set (34 pcs):

48-20001 10.00 set

Grille Bug Screen

48-18700 65.00 ea

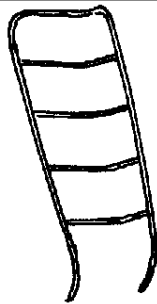

Grille Inner Baffle

Fiberglass

GSP35P 300.00 ea



Hood Side Trim & Hardware

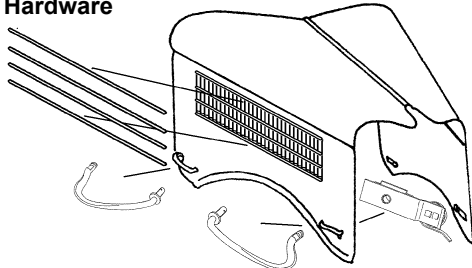

40-16636-BR	Handle, RH front, LH rear, bronze	15.00 ea
40-16636-BL	Handle, LH front, RH rear, bronze	15.00 ea
48-16644/5-B	Handles, set of 4, polished stainless	150.00 set
40-16637-BR	Bracket & Spring, RH front, LH rear	25.00 ea
40-16637-BL	Bracket & Spring, LH front, RH rear	25.00 ea
48-16722	Side trim, stainless, set of 8 with clips	120.00 set
48-20004	Side trim clip set (32 pcs)	10.00 set
48-16761	Hood rubber bumper kit, w/corner rubber	22.50 set

Stock and Street Rod Hoods

Steel Hoods by Rootlieb

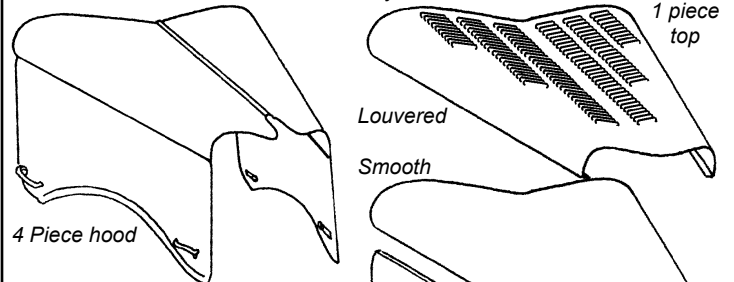

4 Piece hood

1 piece top

Louvered

Smooth

Stock Hood top includes center hinge. Side panels are complete with hood handles and hinge rods.

One piece top panel does not have cutout for ornament. 3 piece Side panels do not have handles. Hood hinges and top panel braces not included, sold separately.

3 piece hood with sides

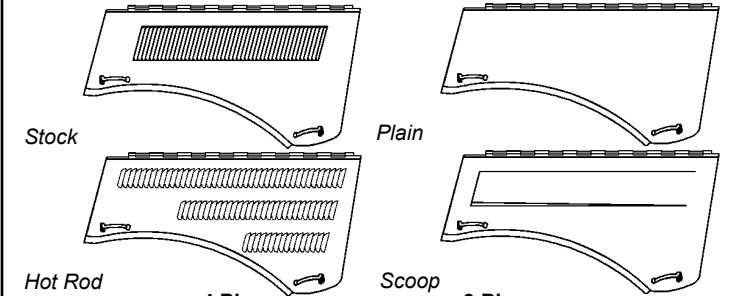

Stock

Plain

Hot Rod

Scoop

	4 Piece		3 Piece	
Top, Smooth	48-16710	500.00 ea	48-16710-3	575.00 ea
Top, 6 rows louvers	48-16710-L	675.00 ea	48-16710-3L	725.00 ea
Sides, Stock louvers	48-16712	not.avbl	48-16713	not.avbl
Sides, Hot Rod Louvers	48-16712-H	325.00 pr	48-16713-H	325.00 pr
Sides, Plain	48-16712-P	325.00 pr	48-16713-P	325.00 pr
Sides, Scoop	48-16712-S	650.00 pr	48-16713-S	650.00 pr

Hood Lacing on Grille or Cowl

40-16739-S	Grille: 1933-35 Pass, fabric w/rivets	12.50 ea
48-16740-S	Cowl: 1935 Passenger, fabric, w/screws	15.00 ea
HR-16739	Foam rubber, 3/8" x 3/16" (most rad shells)	10.00 ea
HR-16740	Foam rubber, 5/8" x 3/8" (most cowls)	12.50 ea

Hinge and Braces for 3-Piece Hoods

Top Panel Braces

3/8" round steel braces provide extra support. This minimizes flexing and helps to avoid cracking paint and smooths operation of hidden hinges.

46-16714-DF Braces 90.00 set

Hidden hinge and latch kit:

By DF Metalworks. Includes hinges, latches, and side panel lower alignment pins. Hardware and instructions are included.

B-16711-DF LH Open 375.00 set
B-16711-DF2 2 Way Open 475.00 set

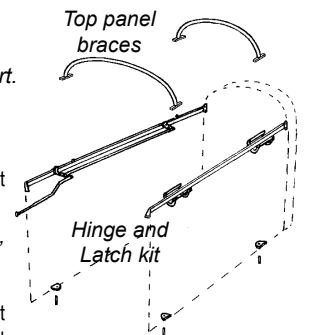

4 Piece Hood Hinge

Hinge Brackets (front or rear)

B-8220	Hinge brackets, stainless	12.50 ea
40-16632	Center hinge strip, stainless	17.50 ea
48-16631-S	Side panel rods, ss, 3/4"	17.50 pr
HR-16780-SS	Accessory hood support mounts to radiator rods	45.00 ea

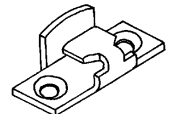

* Parts with price listed as "not.avbl" are not known to be available at this time, but are listed for reference.

1935 Passenger Grille, Hood, Fenders and Running Boards, cont

1935 Passenger Front Fenders, Fiberglass



RFF35P	RH Front fender	550.00 ea
LFF35P	LH Front fender	550.00 ea
RFI35P	RH inner fender	150.00 ea
LF35P	LH inner fender	150.00 ea

Fender Brackets

Fender/headlight support:

48-16025-R	RH:	not.avbl
48-16025-L	LH:	not.avbl
Support bracket to frame strut:		
48-16067-R	RH:	10.00 ea
48-16067-L	LH:	10.00 ea

Skirt brace, RH or LH

48-16094		20.00 ea
----------	--	----------

Rear Fender brace

48-16391	RH or LH	27.50 ea
----------	----------	----------

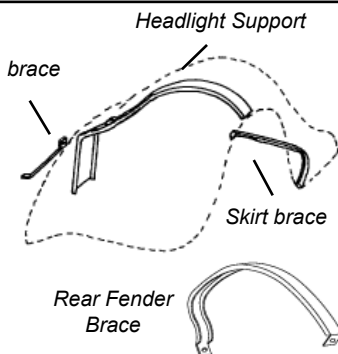

1935-36 Fender Washer Sets

Set of 28 washers, enough for both front and rear fenders.

48-16008-SK		10.00 ea
-------------	--	----------

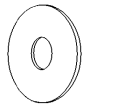

5/16-24 Cage Nuts

Welded to body and frame for fender and running board mounting.

AH-3145	Cage nut	1.50 ea
---------	----------	---------

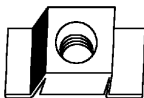

Fender Welt

Black vinyl, 25 ft. length

48-16070-B	3/16" bead	17.50 ea
48-16070-D	1/4" bead	17.50 ea

Vinyl, clad w/stainless bead, 8 ft.

48-16070-SS	7/32" bead	22.50 ea
-------------	------------	----------

Vinyl, COLORED, Use part suffix to indicate color

Maroon: -MR, Caramel: -CR, Medium Blue: -BLM, Red: -RD, Dark Brown: -BRD, Dark Green: -GRD, White: -WH, Grey: -GY, Bright Orange: -OR, Yellow: -YL, Bright Red: -RR

48-16070-xx	25 ft length, Specify Color	35.00 ea
-------------	-----------------------------	----------

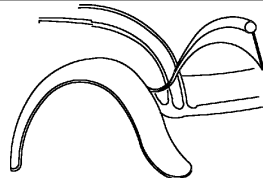

1935 Coupe, Roadster, & Cabriolet Rear Fenders

Fiberglass

Right:		
RRF35CR		425.00 ea

Left:		
LRF35CR		425.00 ea



1935 Sedan & Phaeton Rear Fenders

Fiberglass

Right:		
RRF35SPH		425.00 ea

Left:		
LRF35SPH		425.00 ea



1935-36 Station Wagon & Sedan Delivery Rear Fenders

Fiberglass

Note: Inner flange of fender needs to be trimmed to fit Sedan Delivery

Right:		
RRF3539SD		425.00 ea

Left:		
LRF3539SD		425.00 ea



Teardrop Fender Skirts, Fiberglass

Excellent fiberglass reproductions of the aftermarket bubbled fender skirts that were so popular in the '50's. Includes locking arms to latch to the top of the fender, clamps to the bottom of the skirts to the front and rear of the wheel opening, stainless screws, and rubber seals.

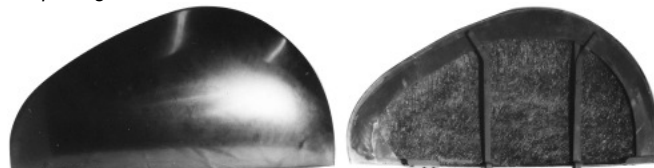

FST3536F	Fender Skirts, fiberglass	650.00 pr
----------	---------------------------	-----------

1935-36 Passenger Running Boards

Fiberglass, smoothie style

Fiberglass boards are very strong, over 1/4" thick. They have the proper arch for excellent fit and appearance



RRB3536PS	RH, smooth running board	400.00 ea
LRB3536PS	LH, smooth running board	400.00 ea

Steel boards and rubber covers:

Steel boards with vulcanized rubber covers are excellent quality.

48-16450/1-BD	Steel boards w/molded rubber cover	1400.00 pr
48-16450/1	Molded rubber replacement covers	225.00 pr
48-16455-MB	1935-48 Running board mount bolt	1.00 ea

1935-36 Passenger Running Board Moldings

48-16462-S	Stainless moldings	95.00 pr
------------	--------------------	----------

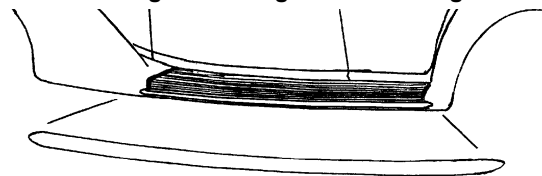

* Parts with price listed as "not.avbl" are not known to be available at this time, but are listed for reference.