

1941-48 Coupe, Convertible and Sedan Body Repair Parts

Street Rod Firewall and Front Floorboards

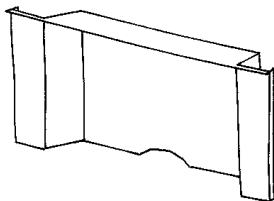

Fabricated steel

BN-421000	Firewall: Smallblock	400.00 ea
BN-421002	Firewall: Bigblock	475.00 ea
BN-421105	Firewall extension, LH, Convertibles	not.avbl
BN-421106	Firewall extension, RH, Convertibles	not.avbl
BN-421004	Floorboard & trans hump	325.00 ea
	Use with original firewalls	
BN-421001	Smallblock floorboard & trans hump	325.00 ea
BN-421003	Bigblock floorboard & trans hump	325.00 ea

Stock Front Floorboard Parts

11A-35190	Steering tube to floor seal, Passenger	15.00 ea
19A-35190	Steering tube to floor seal, Mercury	15.00 ea
11A-7001730	Steering tube to floormat seal	10.00 ea
91A-35184	Bumpers for brake & clutch pedals	7.50 pr
91A-7011136	Master cylinder cover in floor	7.50 ea

Patch Panels, Steel

Sedan Coupe, Tudor Sedan, and Convertible use 43 1/2" "long door" repair panels. Business Coupe, Sedan Delivery, and Fordor front door use 35 1/2" "short door" repair panels

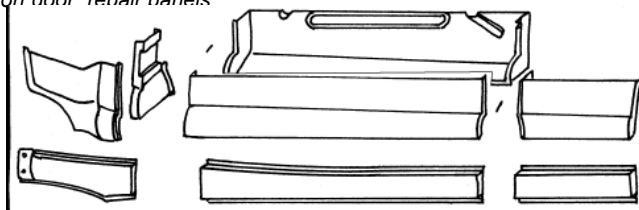

	43 1/2" "long door"		35 1/2" short door	
RH cowl	11A-114-R	210.00 ea	11A-114-R	210.00 ea
LH cowl	11A-114-L	210.00 ea	11A-114-L	210.00 ea
RH door inner/outer	11A-236-IOR	225.00 ea	11A-336-IOR	225.00 ea
LH door inner/outer	11A-236-IOL	225.00 ea	11A-336-IOL	225.00 ea
RH rocker box front	11A-239-FR	130.00 ea	11A-239-FR	130.00 ea
LH rocker box front	11A-239-FL	130.00 ea	11A-239-FL	130.00 ea
RH rocker box center	11A-239-CR	185.00 ea	11A-339-CR	185.00 ea
LH rocker box center	11A-239-CL	185.00 ea	11A-339-CL	185.00 ea
RH rocker box rear	11A-239-RR	85.00 ea	11A-339-RR	85.00 ea
LH rocker box rear	11A-239-RL	85.00 ea	11A-339-RL	85.00 ea
Outer skin only	11A-239	60.00 pr		
RH Quarter	11A-250-R	150.00 ea	11A-350-R	150.00 ea
LH Quarter	11A-250-L	150.00 ea	11A-350-L	150.00 ea

1941-48 Coupe & Sedan Panel Below Deck Lid

Stamped Steel, good quality.

Requires minor reshaping and fitting during installation.

1941-early 1947 panels roll completely under the car and attach to the toolbox or floor and can be used as a full roll style rear pan 1941-48.

Late 1947-48 stopped at the bumper apron.

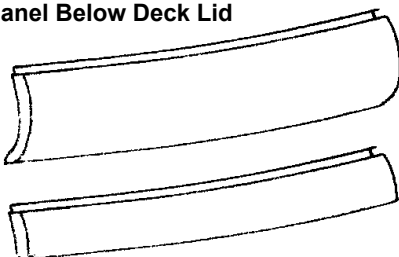

11A-7040320	1941-Early 1947 (full height)	325.00 ea
6A-7040320	1947-48 (half height)	85.00 ea
11A-725250-T	1941-Early 1947 tool tray	160.00 ea

Body Drip Rails

Steel, 4' lengths form to fit

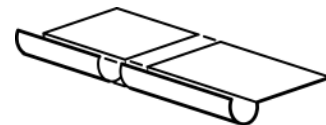

78-7050834-48	Coupe and Sedans	120.00 ea
---------------	------------------	-----------

Street Rod Replacement Floor Kits. These steel floor replacement kits extend from the front floorboards to the trunk area. Driveline tunnel has been redesigned for a flatter look. Manufactured in multiple pieces allowing UPS shipping.

Coupe, Sedans, Convertibles

BN-421034	Center floor (floor to trunk)	325.00 ea
BN-421084	Trunk floor	250.00 kit
BN-421090	Rear seat riser kit	325.00 kit

Station Wagon

BN-421200	Center floor (floor to trunk)	325.00 ea
BN-421201	Rear deck floor	350.00 ea

1941 Convertible Body Wood

VWD-41CNV-SEATH	Rear seat heel board	not.avbl
VWD-41CNV-SEATB	Rear seat hyd cvr wood	not.avbl

1946-48 Convertible Body Wood

VWD-48CNV-SEAT	Rear seat heel board	not.avbl
VWD-48CNV-PACK	Package tray wood	not.avbl

1941-48 Body & Hood Side Trim

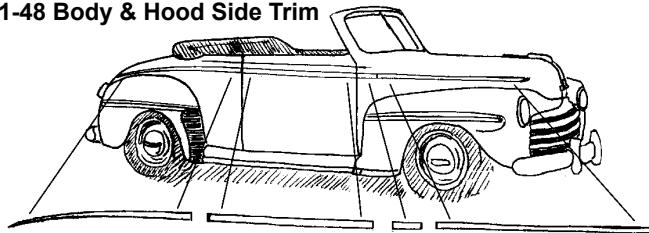

Hood Side & Cowl Stainless Steel Trim Moldings

6A-16722/3-B	Hood Side Moldings	not.avbl
6A-7002328/9-B	Cowl Side Moldings	not.avbl

Front Door Stainless Steel Trim Moldings

6A-7020934/5-B	Tudor, Convertible, Sedan Coupe	175.00 pr
6A-7320934/5-B	5 Window Coupe, 4-Door, Sdn Dly	not.avbl

Rear Quarter Panel Stainless Steel Trim

6A-7029034/5-B	Tudor, Convertible, Sedan Coupe	not.avbl
6A-7329034/5-B	5 Window Coupe	not.avbl

1941-48 Body Side Trim Clips & Bolts

11A-20005	Body Side: 1941 Passenger, (61 pcs)	20.00 set
21A-20005	Body Side: 1942-46 Passenger, (56 pcs)	20.00 set
6A-20005	Body Side: 1947-48 Passenger, (56 pcs)	20.00 set
51A-20012	Deck trim: 1946 Passenger	7.50 set

1941-46 Door Window Reveal Trim Clip Sets

11A-20007	Reveal (2 doors, straight), 40 pcs	12.50 set
11A-20008	Reveal (2 doors, curved), 24 pcs	7.50 set
11A-20009	Reveal (4 doors, straight), 62 pcs	17.50 set
11A-20010	Reveal (4 doors, curved), 24 pcs	10.00 set

* Parts with price listed as "not.avbl" are not known to be available at this time, but are listed for reference.

Special Hardware

Rear Wheelwell Fender Studs

These are the large head studs that weld into the wheelwell for rear fender mounting on 1928-32 Passenger cars and 1932-47 Pickup boxes.

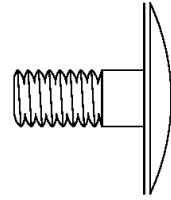

AH-1173	Set of 4	2.50	set
---------	----------	------	-----

Cage Nuts

A nut in a sheetmetal cage to weld or braze into the body.

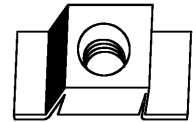

AH-3145-B	43834	1.50	ea
AH-3145	45428	1.50	ea
AH-3145-D	45359	5.00	ea
AH-3145-E	41276	2.50	ea

Capped nuts for exposed wood

Stainless Steel, used extensively on station wagons

AH-352353-SF	5/16-24, .75 cap dia, .35 thread depth	3.00	ea
AH-352353-LL	5/16-18, .75 cap dia, .60 thread depth	3.00	ea
AH-352353-SS	5/16-18, .75 cap dia, .35 thread depth	3.00	ea
AH-352353-SC	3/8-24, .90 cap dia, .60 thread depth	3.00	ea

"D" Nuts

These are the special D shaped clinch nuts used extensively on Ford bodies. They are inserted into their hole and the flange is peened down to rivet them into the hole.



AH-1123-A	11963	0.50	ea
AH-1123	40901	0.50	ea
AH-1123-B	43834	1.00	ea
AH-1123-D	45428	2.50	ea
AH-1123-C	45359	2.50	ea
AH-1123-E	44028	2.50	ea

Body Nails

.074 dia x 3/4", .165 dia, Oval head, straight shank

AH-0003-C	100 qty	1.50	ea
AH-0003-5C	500 qty	7.50	ea

.085 dia x 7/8", .165 dia, flat head, twist shank

AH-0004-C	100 qty	2.00	ea
AH-0004-5C	500 qty	12.50	ea

Body Insulation

HR-700770	Heavy duty foil backed jute 36" x 48"	30.00	ea
-----------	---------------------------------------	-------	----

* Parts with price listed as "not.avbl" are not known to be available at this time, but are listed for reference.