

1932 Roadster and Phaeton Windshield and Top

Typical 1932 Roadster & Phaeton Windshield Components

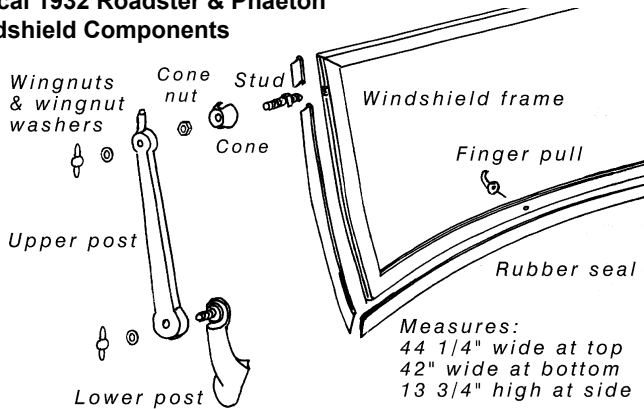

Measures:
44 1/4" wide at top
42" wide at bottom
13 3/4" high at side

Windshield Frame

This is now the windshield frame only. Available with stock holes drilled for wiper shaft and finger pulls or undrilled. Available plain or chrome plated.

	Stock Height		Chopped 2"	
Chrome, stock holes	B-37110	1100.00 ea	B-37110-C2	1100.00 ea
Chrome, no holes	B-37110-N	1100.00 ea	B-37110-CN2	1100.00 ea
Plain, stock holes	B-37110-P	450.00 ea	B-37110-P2	450.00 ea
Plain, no holes	B-37110-NP	450.00 ea	B-37110-PN2	450.00 ea

Upper Windshield Posts

Polished Stainless Steel

B-37138-C	Stock Height,	not.avbl
B-37138-CM	Holes for windwing and LH mirror Chop 2", Hole for LH mirror only	150.00 pr

1932 Lower Windshield Posts

Excellent quality cast bronze lower posts with the same shape and footprint of the original steel. Studs are installed. These are not the same as the poor fitting die cast imported posts available elsewhere.

B-37130-S	Lower posts, plain	450.00 pr
B-37130-SC	Lower posts, chrome	750.00 pr
B-37132-S	Lower post to body pads, rubber	15.00 pr

Windshield Hardware

A-351000	Wingnut, chrome plated (4 required)	10.00 ea
A-351001-SW	Wingnut washer, stainless (4 required)	2.50 ea
18-37118-S	Finger pulls, chrome	15.00 pr
B-37154-S	Cone, fit steel repro frames, chrome	7.50 ea
A-37158-S	Stud & cone nut set	5.00 ea
A-37199-BS	Rubber seal, Fits reproduction steel frame	17.50 ea

Windwing Bracket Sets

Windwings act as side air deflectors on Roadster and Phaeton windshields. They mount to the back side of windshield posts. Chrome Plated, set of 4:

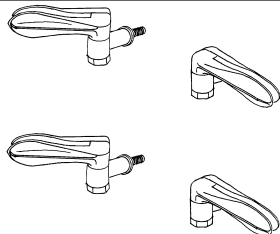

A-18200-B	150.00 set
-----------	------------

DuVal Style Windshield Frames

Cast silicon bronze windshield frame is assembled and ready to mount to cowl. Mounting hardware is included. Duval style frames are unplated.



B-37110-DUV	1932 Roadster & Phaeton	3000.00 ea
-------------	-------------------------	------------

Mirrors

Windshield Center Mirror

B-17681	Beveled glass with stainless bracket	50.00 ea
B-17681-SG	Accessory glass with stainless trim, only	50.00 ea

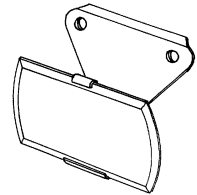

Windshield Post Mirrors

B-17700-P	Chrome arm with stainless back head	60.00 ea
B-17741-MH	Replacement Mirror Heads Flat	22.50 ea
B-17741-MHC	Convex	20.00 ea

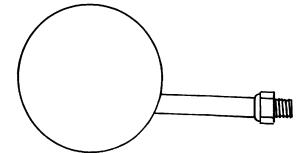

Windwing Mirrors

B-17700-WWSS	Any Year, Chromed, clamps to windwing	not.avbl
--------------	---------------------------------------	----------

Top Irons and Bows Roadster:

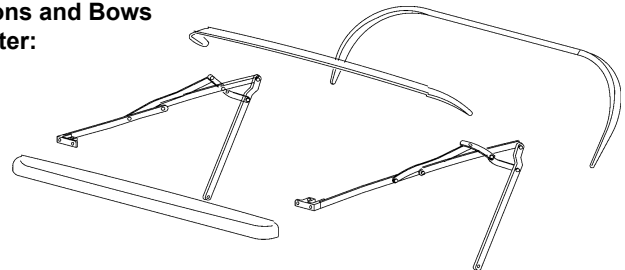

B-42030-PS	Top irons, pln w/stainless arm	1500.00 set
B-42030-PS2	Top irons, chop 2", pln w/stnlis arm	1500.00 set
B-42030-CS	Top irons, stainless	1750.00 set
B-42030-CS2	Top irons, chop 2" stainless	1750.00 set
B-42055-S	Top wood header & 2 bows	525.00 set

Roadster & Roadster PU Top Iron Mounting Parts

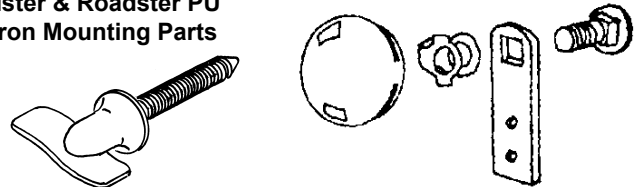

B-37708-B	Top Mount Nut, Stainless Clad	7.50 ea
B-52550	Top Mount Nut Lockwasher	2.50 ea
B-42034-P	Top Mount Bolt, plain	0.50 ea
B-42034-S	Top Mount Nut, stainless clad	0.75 ea
B-42027	Top Mount Bracket on Quarter, Plain	25.00 ea
B-42027-SS	Top Mount Bracket on Quarter, Polished Stnlss	50.00 ea
B-37472	Top Iron to Windshield Thumbscrew, Chrome	12.50 ea

* Parts with price listed as "not.avbl" are not known to be available at this time, but are listed for reference.

1932 Roadster and Phaeton Windshield and Top, cont

Lift Off Hardtop for 1932 Roadster with Chop Windshield

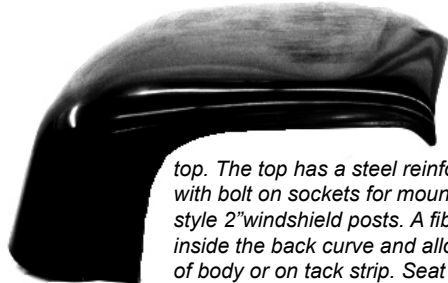

A fiberglass removable hardtop for 1932 Roadster with 2" chopped stock style windshield. This fiberglass top features styling like a '34 Coupe top. The top has a steel reinforced windshield header with bolt on sockets for mounting onto tabs on stock style 2" windshield posts. A fiberglass former is glued inside the back curve and allows top to sit on top of back of body or on tack strip. Seat belt buckles can easily be used to latch the back of the top. The back window opening is molded in and a garnish molding included



TOP32RD2 Hardtop, 32 Roadster w/2" chop windshield 1500.00 ea

Removable Hardtop for DuVal Windshield Roadster

A fiberglass removable hardtop for 1932 Roadster with DuVal style windshield. This fiberglass top features styling like a '34 Coupe top. The top has fiberglass windshield header and back curve formers glued in. Steel plates in the windshield header allow for mounting top latches (not included). The back window opening is molded in and a garnish molding included. Note that a padded upholstery roll on the stock wood cockpit tackstrip cannot be used.

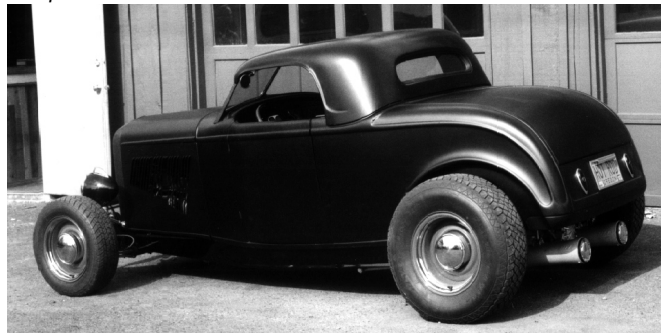

TOP32DUV Hardtop, 32 Roadster w/DuVal windshield 1500.00 ea

Bonneville Style Tonneau Cover for 1932 Roadster

Fiberglass, completely covers cockpit, you cut for drivers opening as desired. This style has been used on a 200+mph 1932 roadster at Bonneville.

TON32WR Tonneau cover 1000.00 ea

1932 Phaeton Top Irons and Bows



B-38700-PS	Top irons, pln w/stainless arm	not.avbl
B-38700-PS2	Top irons, chop 2", pln w/stnls arm	not.avbl
B-38700-CS	Top irons, stainless	not.avbl
B-38700-CS2	Top irons, chop 2" stainless	not.avbl
B-37455-S	Top wood header & 3 bows	825.00 set

Phaeton Top Irons to Body Mounting Parts

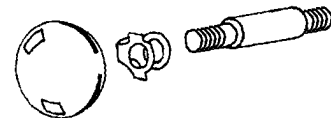

B-37708-B	Top iron to body mount nut, stainless clad	7.50 ea
B-52550	Top mount nut folding lockwasher	2.50 ea
B-36636	Top mount stud on body	25.00 ea

Phaeton Top Rest Saddles

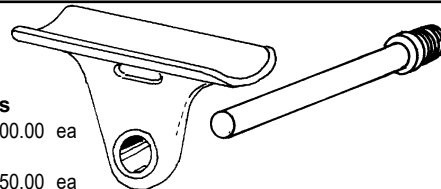

Top Saddle, Cast stainless		
B-37330	100.00 ea	
Top Saddle Stud, steel		
B-37329	50.00 ea	
Set Screw, square head, stainless		
B-37330-SET	2.00 ea	

Roadster Top Tie Down Brackets

Usually called rumble seat grab handles, these are really for resting the top irons on when the top is folded, and to tie it down.

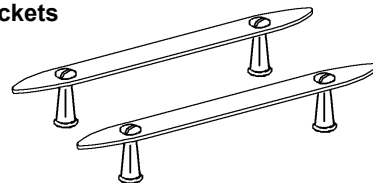

A-41500-SS 45.00 pr

Side Curtain Parts

A-81002	Snap sockets, 1928-37 (in body)	10.00 ea
A-37103	Studs, 1928-36 (for windshield)	45.00 set

Back Window Frames

(glass not included)

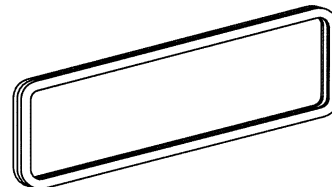

1932 Roadster & Phaeton (20 5/8" x 7" od)

B-37639-PL	Stainless outer/tan inner	not.avbl
B-37639-SS	Stainless outer and inner	not.avbl

Aluminum Mailslot (20" x 4 1/2" od)

H-37639-C	Polished Aluminum	not.avbl
-----------	-------------------	----------

* Parts with price listed as "not.avbl" are not known to be available at this time, but are listed for reference.