

## 1933-34 Cabriolet Windshield and Top

### Windshield Group 1933-34 Cabriolet

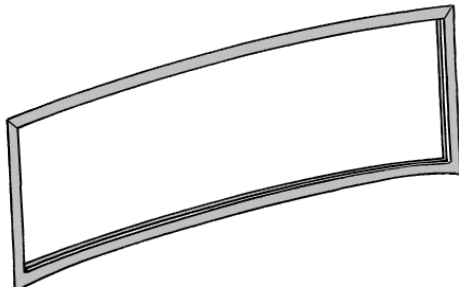

#### Windshield Frame

*Excellent quality steel tubing frames, like original. Frame to body gasket not included.*

40-761210	Chrome, steel	1100.00 ea
40-761210-P	Plain steel	450.00 ea

#### 1932-36 Pass Windshield Frame to Body Seal, Rubber

40-761290	1933-34 Cabriolet	40.00 ea
-----------	-------------------	----------

#### Windshield Glass to Frame Setting Tape

B-37193-A	All years, 20 ft, 1/32"thick	17.50 ea
B-37193-B	All years, 20 ft, 3/64"thick	17.50 ea
B-37193-C	All years, 20 ft, 1/16"thick	25.00 ea
B-37193-D	All years, 20 ft, 5/64"thick	30.00 ea

#### 1932-34 Cabriolet Windshield Side Garnish Moldings

40-46106-CS	1933-34, Stamped steel, plain	70.00 pr
40-46106-CSS	1933-34, Stamped stainless steel	80.00 pr

#### Windshield Center Mirrors

B-17690	1932-34 Cabriolet w/chrome bracket	50.00 ea
B-17681-SG	Accessory glass w/stainless trim for 32-36	50.00 ea

#### Swan Neck Mirror)

*4"chrome head, 6"curved aluminum arm with teardrop base. Mounts with thru bolt into cowl or door panel.*

HR-18402/3-S	Curve neck mirrors	70.00 pr
--------------	--------------------	----------

## 1933-34 Cabriolet Windshield and Top, cont

### Top Header to Windshield Hardware and Seals

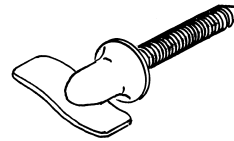

40-761412-S	Top dowel socket (on header), chrome	275.00 pr
40-761416	Top Dowel on windshield, chrome	not.avbl
B-37472	Thumbscrew (chrome plated)	12.50 ea
40-761440-BK	Top header to windshield bumpers, (3pc)	10.00 ea
48-763200	Top header to windshield rubber seal	10.00 ea

### Top Header, Bows, and Wood Parts

40-764855-1	Wood header	375.00 ea
40-764880	Header sheetmetal cover	150.00 ea
40-764855-2	Metal center bow	not.avbl
40-764855-3	Wood rear bow	550.00 ea
40-764855-4	Wood fillers behind door	85.00 pr

### Top Irons

#### Top Iron assemblies:

40-764800-S	Top irons, stock height	not.avbl
40-764800-S2	Top irons, chop 2"	not.avbl

#### Top Iron Components for Cabriolet, Locking lever behind door

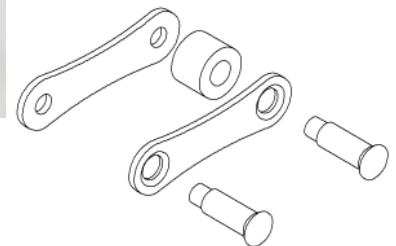

40-764832	Handle (with roller end), stainless	175.00 ea
40-764838	Link, iron to handle, outside, stainless	45.00 ea
40-764858	Link, iron to handle, inside, stainless	45.00 ea
40-764852	Spacer, links to top iron, stainless	35.00 ea
40-764848	Rivet, link to handle, links to iron, stainless	not.avbl

#### Top Iron Components for Cabriolet, Mounting Hinge

40-764930	Hinge pin (Screw)	40.00 ea
-----------	-------------------	----------

### Back Window Frames (glass not included)

**1933-34 Roadster, Phaeton, & Cabriolet  
(24"x 4 7/8"od)**

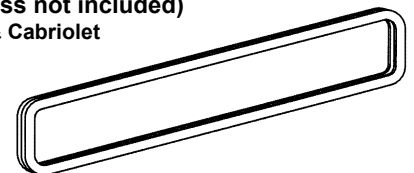

40-37639-PL	Stainless outer/tan inner	325.00 ea
40-37639-SS	Stainless outer/chrome inner	375.00 ea

### Windshield Post and Top to Door Window Seals

*1932-1939 Top to window seals are 1"wide.*

*1933-34 only had seal at front and back of window.*

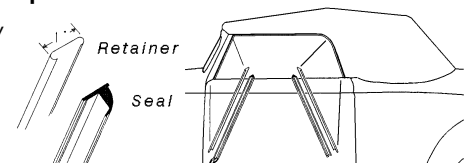

48-7651562	Seal, window to top, 30"length, rubber	5.00 ea
48-7651562-F	Seal, window to top, 30"length, w/felt flocking	7.50 ea
48-7651560-S	Retainer, stainless steel, 30"length	50.00 ea
18-45983-F	Felted flocking, self adhesive, 10 foot	22.50 ea

\* Parts with price listed as "not.avbl" are not known to be available at this time, but are listed for reference.