

## 1933-34 Coupe and Sedan Windshield and Top

### Windshield Group 1933-34 Coupe & Sedan

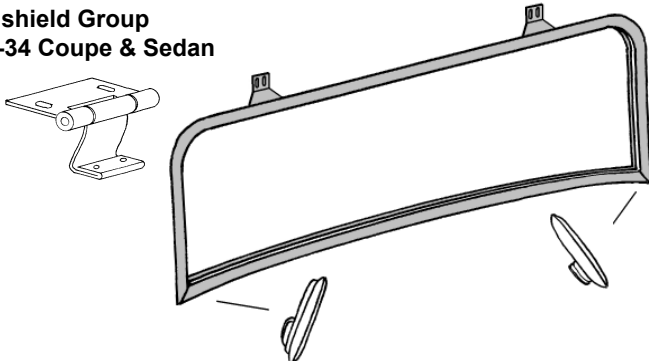

#### Windshield Frame

Windshield frame only. Does NOT include top hinge brackets, corner seam beads or rubber gasket.

40-45410-S	Plain	500.00 ea
40-45410-C	Chrome plated	1100.00 ea

#### Windshield Frame to Body Seal, Rubber

40-701290	1933-34 Closed	20.00 ea
-----------	----------------	----------

#### Windshield Frame Corner Seam Beads

40-701276	Chrome Plated	12.50 pr
-----------	---------------	----------

#### Windshield Frame to Body Hinges

40-701350	Hinges, stamped Steel	70.00 ea
40-701351	Hinge to frame brackets	125.00 pr

### Windshield Regulator

#### Regulator Assembly

40-701325	80.00 ea
-----------	----------

#### Regulator Handle, chrome

40-701348	10.00 ea
-----------	----------

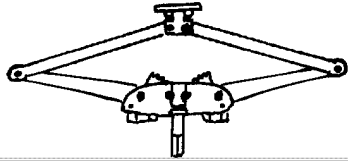

### Windshield Frame Screws

These hold the windshield halves together. New screws should be used when windshield glass is replaced.

B-45410-IS	1932-34 Closed car, set of 8	5.00 set
------------	------------------------------	----------

### Windshield Glass to Frame Setting Tape

B-37193-A	All years, 20 ft, 1/32" thick	17.50 ea
B-37193-B	All years, 20 ft, 3/64" thick	17.50 ea
B-37193-C	All years, 20 ft, 1/16" thick	25.00 ea
B-37193-D	All years, 20 ft, 5/64" thick	30.00 ea

### Traffic signal finder prism

A-18300	Any year	10.00 ea
---------	----------	----------

### 1933-34 Coupe & Sedan

#### Side Garnish Moldings and Header Upholstery Former

WSH3334C	Header upholstery former, fiberglass	175.00 ea
40-46106-S	Side garnish moldings, stamped steel, plain	60.00 pr
40-46106-SS	Side garnish moldings, stamped stainless steel	70.00 pr



### 1933-34 Sun Visor

#### Frames and Brackets, Chrome Plated

40-47380-S	1933-34 Passenger	55.00 pr
------------	-------------------	----------

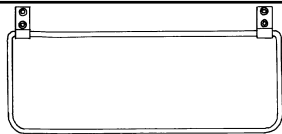

### Windshield Center Mirror

#### Bevel glass mirror w/brown bracket

B-17682-B	not.avbl
-----------	----------

#### Bevel glass mirror w/stainless bracket

B-17682-C	50.00 ea
-----------	----------

#### Accessory glass w/stainless trim

B-17681-SG	50.00 ea
------------	----------

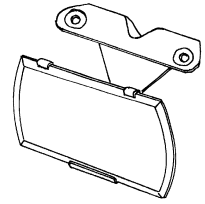

### Peep Mirrors,

Chrome Plated  
Clamps to edge  
of door

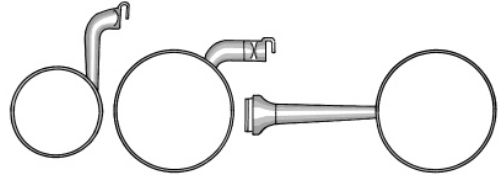

78-18414-PR	3" dia, angled arm, RH	27.50 ea
78-18414-PL	3" dia, angled arm, LH	27.50 ea
B-18414-R	4" dia, angled arm, RH	27.50 ea
B-18414-L	4" dia, angled arm, LH	27.50 ea
A-17741-U	4" dia, straight arm, RH or LH	27.50 ea

### Swan Neck Mirror

4"chrome head, 6"curved aluminum arm with teardrop base. Mounts with thru bolt into cowl or door panel.

HR-18402/3-S	Curve neck mirrors	70.00 pr
--------------	--------------------	----------

### Top Retainer Moldings and Seals

Extruded aluminum retainer moldings.

Must be formed to fit. Coupes use 2 lengths, Sedans and Victorias use 3 lengths. A rubber seal bead is used to seal and hide the attaching nails.

40-705019	Retainer molding, 70"length	not.avbl
B-705020-S	Retainer seal bead, rubber	10.00 ea

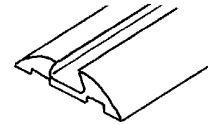

\* Parts with price listed as "not.avbl" are not known to be available at this time, but are listed for reference.